

## FEATURES

- RIGID AND DURABLE BODY
- DROP - FLOW ARE AVAILABLE
- EXCELLENT SEALING STRUCTURE
- FLOW SCALE CAN BE ADDED FOR FLAPPER TYPE



## MODEL SELECTIONS

ITEMS	CODE	SPECIFICATIONS	
① <b>MODEL</b>	644A	Basic type	
	644B	Flapper type	
	644C	Ball type	
	644D	Drop tube type for small flow used	
	644E	Turbine type	
	644F	OEM Versions	
② <b>CONNECTION</b>	- 00	NPT (F)	- 10 ANSI 150 <sup>o</sup> flange
	- 01	PT (F)	- 11 JIS 10K Flange
	- 20	To be specified	
③ <b>MATERIALS OF WET PARTS &amp; BODY</b>	0	FCD / A395	
	1	CF8 / 304S.S. / SCS13	
	2	CF8M / 316S.S. / SCS14	
	3	To be specified	
④ <b>WINDOW MATERIAL</b>	- A	Tempered glass	
	- B	To be specified	
⑤ <b>SEAL MATERIAL</b>	A	NBR	
	B	Viton	
	C	PTFE	
	D	To be specified	
⑥ <b>MATERIALS OF LIDS &amp; BOLTS</b>	A	FC200	
	B	304S.S.	
	C	316S.S.	
	D	To be specified	
⑦ <b>OPTIONAL</b>	A	Not required	
	B	To be special specified	
⑧ <b>PIPE SIZE</b>	- 015	15A (½")	
	- 200	200A (8")	
	- XXX	To be specified	

## DIMENSIONS

m / m

### ■ THREAD CONNECTION

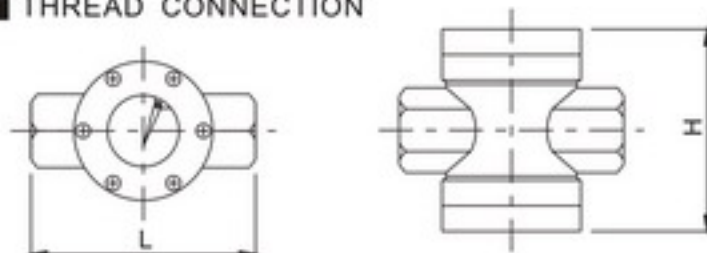

SIZE	15A (½")	20A (¾")	25A (1")	32A (1¼")	40A (1½")	50A (2")
<b>NOMINAL</b>						
H	100	100	105	135	135	145
L	120	120	138	145	145	145

### ■ FLANGE CONNECTION

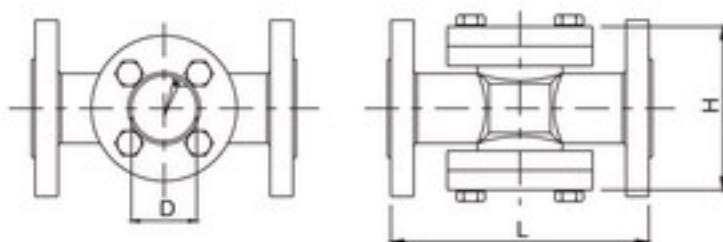

SIZE	NOMINAL	D	H	L
15A	(½")	40	100	130
20A	(¾")	40	100	130
25A	(1")	40	100	170
32A	(1¼")	50	125	200
40A	(1½")	50	125	200
50A	(2")	50	125	220
65A	(2½")	85	167	270
80A	(3")	85	180	270
100A	(4")	110	210	320
125A	(5")	130	270	380
150A	(6")	160	280	420
200A	(8")	160	340	500